



PRODUCT GUIDE

SOLID SECURITY SOLUTIONS



CONTENTS

Securikey Online	02	CASH SAFES & SECURITY CABINETS	16	POST BOXES	32
Welcome	03			FIRE SAFES & CABINETS	33
Certification & Testing	04	Euro Vault	17	Fire Vault & Fire Resistant	34
Locking Options	05	Mini Vault Silver	18	Filing Cabinets	
KEY CONTROL SYSTEMS	06	Mini Vault Gold FR	19	Fire Stor	35
High Security Key Filing Systems	07	Euro Grade 0	20	KEYLEX MECHANICAL DIGITAL LOCKS	36
Key Vault	08	Euro Grade 1	21		
System Cabinets	09	Euro Grade 2	22	CONVEX MIRRORS	38
Specialist Systems	10	Euro Grade 3	23	Interior & Exterior	39
KEY REELS/RETRACTORS/ CASES	12	Euro Grade 4 & 5	24	Speciality	40
Heavy Duty	13	Strongroom & Safety Deposit	25	Institution/Anti Ligature	41
Standard & Light Duty	14	Deposit Safes	26	Portable Inspection/MOT	41
T-Reign Retractors & Cases	14	Underfloor & DIY Safes	27	MASTER LOCK®	42
		Gun Cabinets	28		
		Secure Stor	29		
		Steel Stor	30		
		Medical Storage	31		

SECURIKEY ONLINE

The fifth generation Securikey website features a design focused on user friendly navigation, allowing easy product selection, whilst providing in-depth technical support in both video and printable media. For more detailed information about the company and our products, including **downloadable brochures, price lists, cash and fire ratings, installation guides** and details of your nearest Securikey stockist, please visit **www.securikey.co.uk**. The website is just one method for potential customers to research our products. We welcome you to talk to us directly if the topic is of a more secure or sensitive nature, please call Securikey on 01252 311888.



SUPPORT

The support section of our website contains over 50 videos showcasing many of our products providing a unique video presentation of operation and programming of our more complex products. These are hosted on YouTube as well as the Securikey website.

WHERE TO BUY:

Securikey products can be purchased from our network of distributors and are available from both the high street (for those customers who like to 'try before they buy') and via selected website retailers. For more details please visit our website: www.securikey.co.uk.



WELCOME

For over 40 years Securix has been a trusted partner of many UK companies and institutions, supplying a comprehensive range of innovative security and safety products which meet the requirements of even the most demanding of environments.

Combining our technical expertise and knowledge of security with continued evaluation of customer experience and development of our products, we have provided peace of mind and protection to people, buildings and businesses alike; from the smallest shop to the largest retail store; workshops to factories; Local Authorities to Central Government Agencies; Financial Institutions to NHS Trusts, Schools, Colleges and Universities.

QUALITY • INNOVATION • EXPERTISE

CERTIFICATION & TESTING

INDEPENDENT TESTING

Many Securikey cash and fire safes have undergone independent testing to European standards. Each is approved and certified after undergoing a rigorous and exhaustive series of technical and practical tests, for use within a diverse range of applications and environments. This is signified by the issuing and mounting of the appropriate badge showing the name of the test house and model number.

In addition, Securikey also include an insurance certificate, detailing the recommended level of protection.



£100,000

CASH RATING

Each Securikey safe is tested and classified by the level of security it provides and designated by a cash rating from £1,000 up to £100,000.

For the storage of valuables, ratings can be calculated by multiplying the cash amount by 10. These ratings are a guide and it's important that you liaise with your insurance company prior to any installation.



30mins
750°

FIRE PROTECTION RATING

The level of fire protection provided is indicated by the use of this icon, signifying the temperature and time duration achieved. This rating is established from both our own 'in-house' test and independent testing. In both Sweden and the UK, testing standards include NT017/BS476-20/EN1363-1.

ACCREDITATIONS

In addition to our ISO 9001 certification, Securikey are members of the Master Locksmiths Association (MLA), ESSA and Secured By Design (SBD). All of these organisations promote the highest standards within the security industry. The inclusion of the 'AIS Approved' logo re-enforces the importance of independent testing.



SEURIKEY STANDARDS

Where no clear industry standards exist, Securikey has developed its own rating system to aid product selection. We have applied over 40 years experience within the security industry to these standards, and found them to be an excellent measure of strength and durability.



Gold Rated

Gold

Products which provide the highest possible standard of security in each range.



Silver Rated

Silver

Offering additional security and strength, over and above Bronze level.



Bronze Rated

Bronze

Where a base level of protection or security is required.

INSTALLATION

Our specialist network of installers is able to deliver and fix any of our safes/cabinets within the UK Mainland. The majority of these installations can be carried out by the completion of a simple risk assessment form downloadable from our website www.securikey.co.uk. More complex situations may require a site survey.

GUARANTEE

Securikey branded products offer a 1 year guarantee in respect of materials and workmanship.* This can be increased to 2 years by registering online at www.securikey.co.uk. Master Lock Security branded products carry a lifetime Guarantee.

*Guarantee applicable to the lock is limited to that offered by the lock's manufacturer.

Disclaimer: Title in any goods supplied remains vested in Securikey Limited, until the purchase price, handling and transport charges have been paid. Securikey must be notified within 48 hours of receipt if goods have been damaged in transit. The delivery slip must be marked accordingly. Every effort has been made to ensure that the information in this brochure is correct. We have a policy of continually developing and improving our products and reserve the right to change specification without notice. By virtue of the Trades Description Act 1968 all measurements and weights must be considered approximate.



LOCKING OPTIONS

Unless otherwise stated Securikey products will be supplied with a key lock as standard. The type of lock will depend upon its position within the range. Securikey recognise that there may be a requirement to add or alter the standard locking configuration. It is for this reason we offer the following alternatives.



A REVO B/BR
1 Manager, 39 User Codes
Full function lock with multiple user codes, audit trail and time locking to prevent unauthorised entry during specific time zones.



E MECHANICAL PUSH BUTTON LOCK
A push button lock similar to those used extensively within offices in the UK. This lock type is available in both deadbolt and slam lock option.



I LA GARD 39E
1 Manager, 9 User Codes
VdS Class 2 electronic lock with time delay and 63 event audit trail (software required).



B 3/4-WHEEL MECHANICAL COMBINATION
A combination lock used extensively in the safe industry. Offers in excess of 1 million combinations.



F CL1000
Entry level electronic lock with programmable 4-digit code, designed to replace our standard Cam Lock. May be fitted horizontally or vertical depending on product.



J EDL 77
High quality and extremely reliable electronic lock with selectable code lengths from 4-14 digits, 2 user code option and low battery warning.



C REVO A
1 Manager, 8 User Codes
A heavy duty lock offering up to 9 user codes and time delay of up to 99 minutes.



G WITTKOPP PRIMOR 2000
2 User Codes
VdS Class 2 lock with 2 user code and time delay facility.



K LA GARD 66E
1 Manager, 9 User Codes
Multi user electronic lock with 512 event audit. Programmable features include time delay, time delay override, dual combination, silent alarm and remote signal override.



D PADLOCKING CAM LOCK
Designed to replace our standard Cam Lock, this option accepts a padlock with 8mm diameter shackle (max).



H MAUER CODE COMBI K
A simple to operate 2 user code lock with audible indication. Only available on Secure Stor.



L KABA AXESSOR
4 Managers, 36 User Codes
Designed for use in the high security sector. Provides a wide range of functions such as a User Group management, Courier Code, Dual Mode, Duress Code.

Images shown may not be indicative of the lock fitted

LOCKING OPTIONS GUIDE

LOCKING OPTIONS GUIDE			High Security Key Cabinets	Floor Standing Systems	Key Vault Cabinets	System Key Cabinets	Euro Cylinder Systems	Padlock Security Systems	Key View Systems	Portable Key Systems	Emergency Key Boxes	Mini Vault Silver & Deposit	Mini Vault Gold FR	Euro Grade 0 015-0055	Euro Grade 0085 - 0095	Euro Grade 1015N - 1055N	Euro Grade 1085N - 1780N	Euro Grade 2040N	Euro Grade 2070N - 2780N	Euro Grade 3	Euro Grade 4 - Dual locking	Euro Grade 5 - Dual locking	Protector Under Floor Safes	Steel Stor & Deposit	Secure Stor	Fire Stor S1
Mechanical	Locking Option																									
Standard Cam Lock	●	-	-	-	●	-	●	●	●	●	●	-	-	-	-	-	-	-	-	-	-	-	-	-	-	
3-Wheel Combination	B	▲	▲	▲	▲	-	▲	-	-	-	-	-	-	▲	▲	▲	▲	▲	▲	-	●	●	▲	▲	▲	
4-Wheel Combination	B	■	■	■	■	-	■	-	-	-	-	-	-	■	■	■	■	■	■	▲	▲	▲	■	■	■	
Padlocking Cam Lock	D	-	-	-	▲	-	▲	▲	▲	▲	▲	-	-	-	-	-	-	-	-	-	-	-	-	-	-	
Mechanical Push Button Lock	E	-	-	▲	-	▲	-	-	-	-	-	-	-	-	-	-	-	-	-	-	-	-	-	-	-	
Euro Profile Cylinder	●	-	-	●	-	●	-	-	-	-	-	-	-	-	-	-	-	-	-	-	-	-	-	-	-	
Stuv VdS Class 1 Key Lock	●	●	-	-	-	-	-	-	-	-	-	●	●	-	-	-	-	-	-	-	-	-	-	-	-	
Mauer VdS Class 1 Key Lock	●	-	●	-	-	-	-	-	-	-	-	-	-	●	●	●	●	●	●	-	-	-	●	●	●	
Mauer VdS Class 2 Key Lock	●	-	-	-	-	-	-	-	-	-	-	-	-	-	-	-	-	-	-	●	●	●	-	-	-	
Electronic																										
Revo 'B'	A	■	■	■	■	-	■	-	-	-	-	-	-	-	■	-	■	-	■	▲	■	■	-	■	■	
Revo 'BR' Redundancy Feature	A	■	■	-	-	-	-	-	-	-	-	-	-	-	-	-	-	-	■	▲	▲	-	-	-	-	
Revo 'A'	C	▲	▲	▲	▲	-	▲	-	-	-	-	-	-	-	▲	-	▲	-	▲	-	-	-	-	▲	▲	
CL 1000	F	-	-	-	▲	-	▲	▲	▲	-	-	-	-	-	-	-	-	-	-	-	-	-	-	-	-	
Wittkopp Primor 2000	G	■	■	■	-	-	-	-	-	-	-	■	■	▲	■	▲	■	▲	■	-	-	-	-	■	■	
Mauer Code Combi K	H	-	-	-	-	-	-	-	-	-	-	-	-	-	-	-	-	-	-	-	-	-	-	▲	-	
La Gard 39E	I	■	■	■	■	-	-	-	-	-	-	-	-	-	■	-	■	-	■	■	■	■	-	■	■	
EDL77	J	-	-	-	-	-	-	-	-	-	-	▲	▲	-	-	-	-	-	-	■	■	■	-	-	-	
La Gard 66E	K	■	■	■	■	-	-	-	-	-	-	-	-	-	■	-	■	-	■	■	■	■	-	■	■	
Kaba Axxessor	L	■	■	■	-	-	-	-	-	-	-	-	-	-	■	-	■	-	■	■	■	■	-	■	■	

Key: ● Standard Supply ▲ Standard Option ■ Alternative Option



HIGH SECURITY	07
KEY VAULT	08
SYSTEM CABINETS	09
SPECIALIST SYSTEMS	10



KEY CONTROL SYSTEMS

Effective key management and secure storage is an essential part of any organisation's security strategy. Whether you need a simple key cabinet, a mechanised key control system or a sophisticated key issue and monitoring system, our range of high quality key storage cabinets help to maintain total accountability of large quantities of keys and help prevent unauthorised access within domestic, commercial and industrial environments.

EFFECTIVE KEY MANAGEMENT • SECURE STORAGE • MULTIPLE LOCKING OPTIONS
2,000+ KEY POSITIONS • GRADED SECURITY STANDARDS



Gold Rated



HIGH SECURITY KEY FILING SYSTEMS

The ultimate in Key Control

Our range of high security key control systems, the most comprehensive available, is manufactured utilising the same technology as our cash safes and tested to the highest standards, making them ideal for safeguarding against lost or stolen keys even within high security commercial applications, such as the UK's Prestige Motor Dealers, Police Stations and Banks.

HIGH SECURITY:

- Body constructed from 3mm steel.
- 6mm slab door.
- Three-way locking mechanism with 20mm diameter bolts.
- Features include adjustable hook bars, clever key tags and index control.
- Available in deeper models for the storage of bunches of keys.

FLOOR STANDING SYSTEMS:

- Based upon the FireStor (page 35) our Floor Standing systems are larger capacity key cabinets. Their key panels are on telescopic slides for easy access and storage.
- These units are AiS approved.



BC

HIGH SECURITY SYSTEMS

Model	External Dimensions (mm)			Weight (kg)	Holds up to
	Height	Width	Depth		
High Security 60	436	460	120	25	60 keys
High Security 100	636	460	120	35	100 keys
High Security 150	636	460	200	43	150 keys
High Security 200	636	460	200	46	200 keys
High Security 300	636	460	300	53	300 keys

HIGH SECURITY DEEP SYSTEMS

Model	External Dimensions (mm)			Weight (kg)	Holds up to
	Height	Width	Depth		
High Security Deep 50	635	455	180	38	50 bunches
High Security Deep 100	1,100	455	180	62	100 bunches

HIGH SECURITY ELECTRONIC KEY SAFE 80

Model	External Dimensions (mm)			Weight (kg)	Holds up to
	Height	Width	Depth		
Key Safe 80	450	310	150	19.5	80 keys



BC

30mins
750°

FLOOR STANDING SYSTEMS

Model	External Dimensions (mm)			Weight (kg)	Holds up to
	Height	Width	Depth		
Floor Standing 960	860	600	520	104	960 keys
Floor Standing 1560	1,220	600	520	134	1,560 keys
Floor Standing 2160	1,580	600	520	165	2,160 keys

MULTIPLE LOCKING OPTIONS AVAILABLE – SEE PAGE 5



Floor Standing System 960



High Security Deep 100



KeySafe 80



High Security Deep –
Double Spaced Hook Bars



Telescopic Key Panels



Silver Rated

KEY VAULT

Advanced key management

Designed to meet the requirements of insurance companies in the control, tracking and security of keys associated with risk to valuables or property, our range of Key Vaults offer double the security and strength provided by our System cabinets.

- Constructed from 2.5mm fabricated steel.
- Flush closing door for added security.
- Supplied as standard with euro profile cylinder lock enables integration in to a buildings master key system.
- Key Vaults include adjustable hook bars, matching key tabs, removable control index.
- Deeper model available for storage of bunches of keys.
- Ideal for commercial use.
- Includes security seals and loops to secure keys that require clear evidence of tampering or removal.

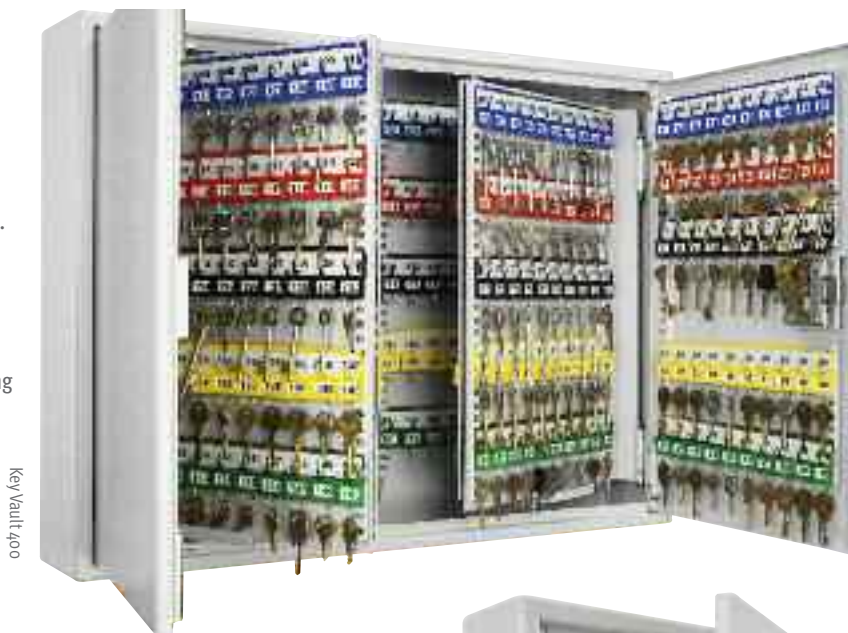

Key Vault 400



KEY VAULT

Model	External Dimensions (mm)			Weight (kg)	Holds up to
	Height	Width	Depth		
Key Vault 30	305	230	70	6	30 keys
Key Vault 48	355	300	80	8	48 keys
Key Vault 100	550	380	80	13	100 keys
Key Vault 200	550	380	140	20	200 keys
Key Vault 400	550	730	140	34	400 keys
Key Vault 600	550	730	205	43	600 keys

DEEP KEY VAULT

Model	External Dimensions (mm)			Weight (kg)	Holds up to
	Height	Width	Depth		
Key Vault 48 Deep	355	300	140	8	48 bunches
Key Vault 100 Deep	550	380	140	14	100 bunches
Key Vault 200 Deep	550	730	140	30	200 bunches

KEY VAULT PADLOCK

Model	External Dimensions (mm)			Weight (kg)	Holds up to
	Height	Width	Depth		
Key Vault 28 Padlocks	355	300	140	8	28 padlocks
Key Vault 50 Padlocks	550	380	140	14	50 padlocks
Key Vault 100 Padlocks	550	730	140	30	100 padlocks

MULTIPLE LOCKING OPTIONS AVAILABLE – SEE PAGE 5



Key Vault with Push Button Combination Lock



Euro Profile Cylinder



Dead Lock or Slam Latch Case



Bronze Rated

SYSTEM CABINETS

Affordable key control

These cabinets are best suited to domestic and commercial use for key control and tracking. Constructed from pressed and folded steel and secured with a choice of multiple locking options, the cabinets provide the space to store and track up to 600 keys and include adjustable hook bars to accommodate different key lengths. Each model has a removable control index for out-of-hours peace of mind, colour-coded hook bars and tags to ensure quick identification, both of which are numbered. For larger requirements, our range of deep system cabinets provide the extra space required to accommodate bunches or a mixture of bunches and individual keys.

- Includes security seals and loops to secure keys that require clear evidence of tampering or removal.



BCDF

SYSTEM CABINETS

Model	External Dimensions (mm)			Weight (kg)	Holds up to
	Height	Width	Depth		
System 20 ¹	260	185	80	2	20 keys
System 30	305	215	80	3	30 keys
System 35	320	245	80	3	35 keys
System 48	355	300	80	4	48 keys
System 64	450	300	80	5	64 keys
System 100	550	380	80	8	100 keys
System 150	550	380	140	13	150 keys
System 200	550	380	140	14	200 keys
System 250	550	380	205	17	250 keys
System 300	550	380	205	18	300 keys
System 400	550	730	140	23	400 keys
System 500	550	730	205	32	500 keys
System 600	550	730	205	34	600 keys

¹ No control index.

DEEP SYSTEMS

Model	External Dimensions (mm)			Weight (kg)	Holds up to
	Height	Width	Depth		
System 35 Deep ²	320	245	100	3	35 bunches
System 48 Deep	355	300	120	5	48 bunches
System 100 Deep	550	380	140	8	100 bunches
System 150 Deep	550	380	205	14	150 bunches
System 200 Deep	550	730	140	18	200 bunches

² Available as key locking only.



E

EURO CYLINDER SYSTEMS

Model	External Dimensions (mm)			Weight (kg)	Holds up to
	Height	Width	Depth		
System 20 Euro	305	215	80	3	20 keys
System 48 Euro	355	300	80	4	48 keys
System 100 Euro	550	380	80	8	100 keys

MULTIPLE LOCKING OPTIONS AVAILABLE – SEE PAGE 5

System 100



System 35



Security Seal and Loops



Padlocking Cam Lock



Bronze Rated

SPECIALIST SYSTEMS

Having all the same features and benefits of our System cabinets, this specialist range of products has been designed to suit specific applications. Examples of this are cabinets designed to house padlocks and keys used to isolate switchgear or machinery, clear fronted cabinets for instant visual check of all stored keys and emergency key boxes to house a restricted key near to a locked door in case of emergency.



B C D F



System 35 Portable

System 50 Key View



PADLOCK SECURITY SYSTEMS

Model	External Dimensions (mm)			Weight (kg)	Holds up to
	Height	Width	Depth		
System 24 Padlock ¹	355	300	120	5	24 padlocks
System 50 Padlock ¹	550	380	140	10	50 padlocks
System 100 Padlock ¹	550	730	140	17	100 padlocks

¹ Padlocks not supplied.



D F

KEY VIEW SYSTEMS

Model	External Dimensions (mm)			Weight (kg)	Holds up to
	Height	Width	Depth		
System 24 Key View	355	300	80	4	24 keys
System 32 Key View	450	300	80	5	32 keys
System 50 Key View	550	380	80	6	50 keys



D F

PORTABLE KEY SYSTEMS

Model	External Dimensions (mm)			Weight (kg)	Holds up to
	Height	Width	Depth		
System 20 Portable ²	260	185	80	2	20 keys
System 30 Portable	305	215	80	3	30 keys
System 35 Portable	320	245	80	3	35 keys
System 63 Portable	320	245	100	5	63 keys

² No control index.



Padlock Security System

PADLOCK SECURITY SYSTEMS:

- Designed to house padlocks and keys to isolate switchgear or machinery.
- Available in 3 sizes.
- Holds up to 100 locks.
- Fitted with extra deep hooks, staggered and spaced 54mm apart.

KEY VIEW SYSTEMS:

- Key View has the same features and benefits as our System Key Cabinets.
- Key View cabinets have a plexi-glass front for easy viewing of stored keys.
- Holds up to 50 keys.

MULTIPLE LOCKING OPTIONS AVAILABLE – SEE PAGE 5

SPECIALIST SYSTEMS



Eurograded Safe with
bespoke key rails



Combi Key Cabinet with 50 Hooks



Emergency Key
Box Range



COMBI CABINETS

Model	External Dimensions (mm)			Weight (kg)	Holds up to
	Height	Width	Depth		
Combi Key Cabinet 50 Hook ⁵	550	380	205	14	50 keys
Combi Key Cabinet 100 Hook ⁶	550	730	205	20	100 keys
Combi 4 Cupboard Expander Unit	550	380	205	10	

⁵ Includes 2 internal cupboards and shelves. ⁶ Includes 4 external cupboards.



EMERGENCY KEY HOLDING BOXES

Model	External Dimensions (mm)			Weight (kg)	Number of Hooks
	Height	Width	Depth		
Ko ³	153	120	40	1	1
K1 ⁴	153	120	40	1	1
K1SF – Solid Front ⁴	153	120	40	1	1
K1PHZ – To suit Euro Cylinder	155	123	50	1.3	1
K1LO – Safety Lockout ⁴	155	155	63	1	3
K1LO5 ⁴	155	120	63	1	1

³ Has no lock, but provision for a seal. Supplied with a hammer and chain plus 2 seals. ⁴ Fitted with cylinder lock.

MULTIPLE LOCKING OPTIONS AVAILABLE – SEE PAGE 5

BESPOKE KEY SECURITY:

- This unit combines the security of a graded safe with our telescopic panels and additional storage. Securikey are able to design and manufacture to suit your specific requirements.

COMBI CABINETS:

- Designed to offer key control/security and safe storage for personal possessions.
- Ideal for commercial and industrial premises.
- Available in 3 models.
- Holds up to 100 keys.
- The key control section is fitted with a digital electronic lock as standard while the lockers are fitted with security cam locks.

EMERGENCY KEY HOLDING BOXES:

- Steel construction with 2mm break glass or solid front.
- Available in 5 models:
Ko – Glass front with security seal & chained hammer
K1 – Glass front with security cam lock
K1SF – Solid front with security cam lock
K1PHZ – Solid front for euro profile cylinder
K1LO/K1LO5 – Solid front with security cam lock & provision for up to 12 padlocks. (K1LO5 – 10 Padlocks).



HEAVY DUTY	13
STANDARD & LIGHT DUTY	14
T-REIGN RETRACTORS AND CASES	14
ACCESSORIES	15



KEY REELS AND RETRACTORS

Four decades after our first Key Reel was produced, millions are in use worldwide in hundreds of different professions, by people who require high-quality products they can depend on daily. From drivers to porters, security guards to shopkeepers, our key reels and retractors are a convenient and secure way for keeping keys, tools and ID badges to hand at all times. Lightweight and durable, they can fasten to either belts or clothing and are available in a range of 'own-branded' models to suit individual company requirements.

RUGGED CONSTRUCTION • CHOICE OF 60+ MODELS • WILL HOLD UP TO 22 KEYS
STAINLESS STEEL CHAIN AND KEVLAR CORD • KEYS, BADGES & TOOLS • INDUSTRIAL / COMMERCIAL USE



Gold Rated

KEY REELS AND RETRACTORS

HEAVY DUTY

Available in both heavy duty and extra heavy duty retraction forces, the popular SUPER48 key retractor offers a case made from a durable polycarbonate material. Attachment to your belt is achieved either by a metal spring clip that converts to a belt loop (with the pin supplied) or a leather loop that slides easily onto a belt. Our other Heavy Duty models are manufactured with either an ABS or stainless steel case, combined with high strength Kevlar cord, to give a lifetime of service.

EXTRA HEAVY DUTY:

- Carries additional weight. Ideal for use with GPS devices, torches and tools.

HEAVY DUTY:

- Endurance tested to withstand 500,000 pulls.
- Kevlar is stronger and lighter than steel on an equal-weight basis.
- Super 48 has a patented ball-joint feature, which secures the keys firmly in place.
- With 4 methods of attachment, there is a model to suit all applications.



Karabiner Clip (RKK)



Key Silencer & Reel (RKSBLSC60)



Super 48 (RHDK)



Midi Key Reel (RMBXCBSPP)

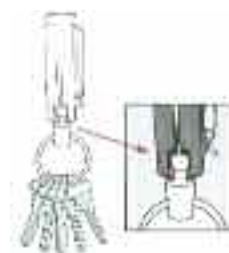

Super 48 Ball Joint



EXTRA HEAVY DUTY & HEAVY DUTY

Strength	Fixing	Description	Code	Weight Carried	Approx. Keys Carried
Extra Heavy Duty	Spring Clip & Belt Loop	Key Reel, Super 48, 900mm Kevlar Cord	RHDKHD	Up to 425g	22
Heavy Duty	Spring Clip & Belt Loop	Key Reel, Super 48, 1200mm Kevlar Cord	RHDK	Up to 284g	15
Heavy Duty	Leather Belt Loop	Key Reel, Super 48, 1200mm Kevlar Cord	RHDKLBL	Up to 284g	15
Extra Heavy Duty	Belt Loop	Key Silencer & Reel, 900mm Kevlar Cord	RKSBLKC90	Up to 425g	22
Heavy Duty	Spring Clip	Key Reel, 1200mm Kevlar Cord	RSCHDK	Up to 284g	15
Heavy Duty	Belt Loop	Key Reel, 1200mm Kevlar Cord	RBLHD	Up to 284g	15
Heavy Duty	Spring Clip & Spinner	Key Reel, 1200mm Kevlar Cord	RSPHD	Up to 284g	15
Heavy Duty	Karabiner Clip	Key Reel, Karabiner, 1200mm Kevlar Cord	RKK	Up to 284g	15
Heavy Duty	Spring Clip & Spinner	Midi Key Reel, 900mm Polyester Cord	RMBXCBSPP	Up to 170g	10



Silver Rated



Bronze Rated

STANDARD & LIGHT DUTY

All standard duty key reels feature 600mm of stainless steel chain housed in either an ABS or stainless steel case. With 5 alternative methods of fixing including Spring Clip, Belt Loop, Spinner, Bracket mount and Karabiner clip. This range of products is best suited for light commercial and domestic use. The light duty range is perfect where there is a requirement to hold an ID or access control card. These can be pinned or clipped to a lapel or waistband.

STANDARD DUTY:

- Keeps your keys within easy reach.
- Allows keys to be used at arm's length.
- Key silencer and key tab models accept a 57mm wide belt.
- Bracket mounted model keeps vital equipment or tools to hand.

LIGHT DUTY:

- No more lost or misplaced ID/Swipe cards.
- Small, lightweight and easy to use.
- Cards can be used at arm's length and return smoothly after use.
- Own branding option for corporate clients.

ACCESSORIES:

- Products designed to complement our Heavy and Standard Duty ranges.
- Models include, key rings, key carriers and key chains.



Key Reel & ID Badge Holder (RSK)

ID/Swipe Card & Reel (RMBIDCB)

T-REIGN RETRACTORS & CASES

The T-Reign range of Retractors and Cases are a new addition to the Key Reel range supplied for over 40 years by Securikey. Designed and manufactured in the USA they are built to last and particularly suited to use in industrial and commercial areas. These products are great for securing tools, radios and phones for people working at height or in situations where the loss of an item could cause production downtime or injury on site.



Pro Holster with integrated Retractor



Pro Case with integrated Retractor



Small Retractor With Spring Clip (TRG412)

Medium Retractor With Karabiner (TRG421)



XD Large Retractor With Strap (TRG433)





STANDARD DUTY

Strength	Fixing	Description	Code	Weight Carried	Approx. Keys Carried
Standard Duty	Spring Clip	Key Reel, 600mm Stainless Steel Chain	RSCA	Up to 284g	15
Standard Duty	Belt Loop	Key Reel, 600mm Stainless Steel Chain	RBLB	Up to 284g	15
Standard Duty	Spring Clip & Spinner	Key Reel, 600mm Stainless Steel Chain	RSP	Up to 284g	15
Standard Duty	Bracket	Key Reel, 600mm Stainless Steel Chain	RBM	Up to 284g	n/a
Standard Duty	Karabiner Clip	Key Reel, Karabiner, 600mm Stainless Steel Chain	RKCH	Up to 284g	15
Standard Duty	Belt Loop	Key Silencer & Reel, 600mm Stainless Steel Chain	RKSBLSC60	Up to 284g	15
Standard Duty	Belt Loop	Key Tab & Reel, 600mm Stainless Steel Chain	RKTBLSC60	Up to 284g	15

LIGHT DUTY

Strength	Fixing	Description	Code	Weight Carried	Approx. Keys Carried
Light Duty	Spring Clip	Key Reel, 910mm Nylon Cord Twin Pack Split Ring	RMBCB	Up to 56g	4
Light Duty	Spring Clip	ID/Swipe Card Reel, 910mm Nylon Cord Twin Pack	RMBIDCB	Up to 56g	n/a
Light Duty	Karabiner Clip	Key Reel & ID Badge Holder, 600mm Kevlar Cord	RSK	Up to 112g	6

T-REIGN

Strength	Fixing	Description	Code	Weight Carried
Light Duty	Karabiner	Retractor, Small Black, 600mm Kevlar Cord	TRG411	Up to 113g
Light Duty	Spring Clip	Retractor, Small Black, 600mm Kevlar Cord	TRG412	Up to 113g
Light Duty	Nylon Strap	Retractor, Small Black, 600mm Kevlar Cord	TRG413	Up to 113g
Standard Duty	Karabiner	Retractor, Medium Black, 900mm Kevlar Cord	TRG421	Up to 170g
Standard Duty	Spring Clip	Retractor, Medium Black, 900mm Kevlar Cord	TRG422	Up to 170g
Standard Duty	Nylon Strap	Retractor, Medium Black, 900mm Kevlar Cord	TRG423	Up to 170g
Standard Duty	Karabiner	Retractor, Large Black, 1,200mm Kevlar Cord	TRG431	Up to 226g
Standard Duty	Spring Clip	Retractor, Large Black, 1,200mm Kevlar Cord	TRG432	Up to 226g
Standard Duty	Nylon Strap	Retractor, Large Black, 1,200mm Kevlar Cord	TRG433	Up to 226g
Heavy Duty	Karabiner	Retractor, XD Large, 900mm Kevlar Cord	TRG441	Up to 397g
Heavy Duty	Spring Clip	Retractor, XD Large, 900mm Kevlar Cord	TRG442	Up to 397g
Heavy Duty	Nylon Strap	Retractor, XD Large, 900mm Kevlar Cord	TRG443	Up to 397g

Details of Pro Cases and Holsters can be found at www.securikey.co.uk

RETRACTOR WITH KNIFE

Strength	Fixing	Description	Code
Standard Duty	Karabiner	Retractor With Safety Knife, 900mm Polyester Cord	RKRKN

ACCESSORIES

Strength	Fixing	Description	Code
Standard Duty	Belt Loop	Key Silencer & Removable Key Carrier	RKSBLKRKC
Standard Duty	Karabiner Clip	Key Ring With Karabiner Clip	RKKRL
Standard Duty	Belt Loop	Key Silencer With Key Ring	RKSBLR
Standard Duty	Trigger Snap	Key Chain, 420mm	RKCTS
Standard Duty	–	Key Rings, 'Pull Apart'	RKR
Standard Duty	–	Spare Blades, Packs of 100	RKRKNBLA
Standard Duty	–	Spare Blades, Packs of 5	RKRKNBLA-5PK



EURO VAULT	17
MINI VAULT SILVER	18
MINI VAULT GOLD FR	19
EURO GRADE 0	20
EURO GRADE 1	21
EURO GRADE 2	22
EURO GRADE 3	23
EURO GRADE 4 & 5	24
STRONGROOM & SAFETY DEPOSIT	25
DEPOSIT SAFES	26
UNDERFLOOR & DIY	27
GUN CABINETS	28
SECURE STOR	29
STEEL STOR	30
MEDICAL CABINETS	31
POST BOXES	32



CASH SAFES & CABINETS

Our range of freestanding safes offers the most comprehensive selection, whilst maintaining clear areas of speciality. Each safe is given a cash rating depending on its ability to resist attack, which is designed to help you choose the model which best meets your needs. Our Euro Graded Safes offer maximum protection with full Vds Test House approval and provides a robust solution for storing money and valuables in either domestic or commercial environments.

MULTIPLE SIZE OPTIONS • SECURE STORAGE • CERTIFIED AND TESTED
ALTERNATIVE LOCKING OPTIONS • DOMESTIC & COMMERCIAL USE



Bronze Rated

EURO VAULT

(£1,500 cash rating)*

Utilizing the same build quality as our Mini Vault range these safes will take a laptop, cash drawer, box file or valuables and are available with either a motorised electronic lock with keypad for the convenience of keyless entry or Euro Profile Cylinder, for those customers who wish to integrate their safe with house or business security arrangements. Perfect for any situation where cost and flexibility are paramount.

KEY LOCK VERSION:

- Manufactured with a 2mm body and 4mm anti-bludgeon flush fit door, with 20mm hardened steel locking bolts.
- Supplied with Euro Profile half cylinder. 40mm length.

ELECTRONIC VERSION:

- Locking is via a motorised lock with keypad.
- The lock has a single use code similar to those used in hotels, this means the user code can be changed each time the safe is used.
- A management override key and master code ensures emergency entry at all times.

GAS STRUT ELECTRONIC:

- Designed to allow installation in areas with limited access, this unit has a larger door and integrated light.
- Hinged door with gas strut assistance.
- Locking is via a motorised lock with keypad.



Euro Vault Gas Strut



Gas Strut Internal Light



Euro Profile Cylinder Locking



Euro Vault Electronic



£1,500

EURO VAULT

Model	External Dimensions (mm)			Internal Dimensions (mm)			Weight (kg)	Volume (l)	Shelves
	Height	Width	Depth	Height	Width	Depth			
Euro Vault Key	200	500	400	195	495	350	17	34	–
Euro Vault Electronic	200	500	400	195	495	350	17	34	–
Euro Vault Gas Strut	150	400	350	95	395	345	12	13	–

* Insurance ratings may vary dependent on risk & location. Please check with your insurers.



Silver Rated

MINI VAULT SILVER

(£4,000 cash rating)*

The Mini Vault Silver is ideal for the safekeeping of cash and valuables. Whilst the manufacturing techniques used provide a robust unit for domestic and commercial applications, its internal fittings are those you would expect to protect delicate valuables, such as watches, jewellery and electronic tablets. This protection is achieved by utilising an anti-bludgeon laser cut door (to prevent prying and chisel attack) mounted on concealed hinges and hardened steel plates to protect all vulnerable areas.

- Manufactured with a 4mm body and 8mm anti-bludgeon flush fit door, with 25mm hardened steel locking bolts.
- Available in 4 sizes, plus 2 deposit options.
- A choice of key or electronic locking mechanisms, the electronic options offers changeable codes, low power warning and LED indicators.
- All models have felt lined walls, thick foam base pad, jewellery shelf** and battery operated motion sensitive light.
- Mini Vault 3 has been designed to accommodate a till or jewellery draw of a width 410mm.



Jewellery Shelf



Concealed Hinge & Dog Bolt

Mini Vault Silver Range



MINI VAULT SILVER

Model	External Dimensions (mm)			Internal Dimensions (mm)			Weight (kg)	Volume (l)	Shelves
	Height	Width	Depth	Height	Width	Depth			
Mini Vault 0	250	374	274	240	354	210	22	18	–
Mini Vault 1	294	374	325	282	354	260	29	26	1
Mini Vault 2	532	374	425	522	354	360	52	67	2
Mini Vault 3	470	435	405	455	420	355	52	68	1

* Insurance ratings may vary dependent on risk, locking and location. Please check with your insurers. ** Where applicable

MULTIPLE LOCKING OPTIONS AVAILABLE – SEE PAGE 5 • DEPOSIT OPTIONS AVAILABLE – SEE PAGE 26



Gold Rated

MINI VAULT GOLD FR

(£4,000 cash rating)*

The Mini Vault Gold FR is ideal for the safekeeping of documents, valuables and cash. Whilst the manufacturing techniques used are intrinsically the same as Mini Vault Silver the FR model benefits from a double walled construction, with a fire resistant barrier material to DIN 4102. The inclusion of this second level of protection gives the FR model its fire protection.

- Combined body thickness of 6mm, an 8mm anti-bludgeon door with 25mm hardened steel locking bolts.
- Available in 4 sizes.
- Choice of key or electronic locking mechanisms. The electronic options offer changeable codes, multiple users, low power warning and LED indicators.
- All models include jewellery shelf** and battery operated motion sensitive light, fixing bolts, batteries and operating instructions.



Mini Vault 3 FR



Mini Vault Gold FR Range



GJ £4,000

MINI VAULT GOLD FR

Model	External Dimensions (mm)			Internal Dimensions (mm)			Weight (kg)	Volume (l)	Shelves
	Height	Width	Depth	Height	Width	Depth			
Mini Vault 0 FR	250	374	274	138	304	168	25	7	–
Mini Vault 1 FR	294	374	325	182	304	220	32	12	1
Mini Vault 2 FR	532	374	425	420	304	320	62	41	2
Mini vault 3 FR	470	435	405	350	360	305	62	38	1

* Insurance ratings may vary dependent on risk, locking and location. Please check with your insurers. ** Where applicable.

MULTIPLE LOCKING OPTIONS AVAILABLE – SEE PAGE 5



EURO GRADE o

(£6,000 cash rating)*

Constructed to exceed the criteria laid down by the insurance and security industry, these Euro Grade 'o' safes are also designed to blend in with today's modern environments, a subtle combination of material and components that function well beyond our customers expectations. The lightweight construction encourages increased installation opportunities with fixing made through twin anchor points.

- £6,000 overnight cash cover (£60,000 valuables)*
- 30 minutes protection from fire at 750°C – BS476-20
- Manufactured in accordance with EN 1143-1:2005 and independently tested and certified by VdS test house
- 3-way square locking bolt work, with continuous hinge side protection
- Door open to 205° for maximum access
- Fitted with VdS class 1 double bitted safe lock & 2 keys
- Optional combination or electronic locking available
- Internal door pan is locked to prevent tampering
- Supplied with adjustable (50mm intervals)/removable shelf
- Deposit Models available



Electronic Locking Option



Adjustable Shelf

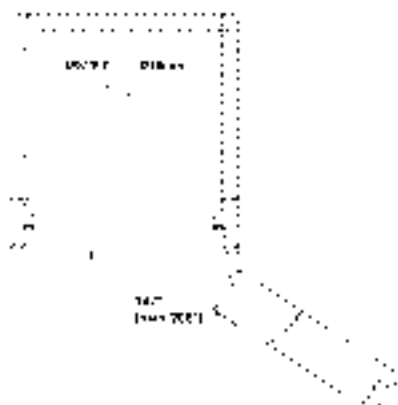

EG0095



EURO GRADE o SINGLE KEY LOCK

Model	External Dimensions (mm)			Internal Dimensions (mm)			Approx. Weight (kg)	Volume (l)
	Height	Width	Depth ¹	Height	Width	Depth		
EG0015 ²	395	325	300	334	275	180	72	17
EG0025 ²	395	405	345	334	355	225	91	27
EG0035 ²	395	405	425	334	355	305	105	36
EG0055 ²	570	405	425	509	355	305	135	55
EG0085	570	505	495	509	455	375	172	87
EG0095 ³	755	505	425	694	455	305	192	96

¹Excludes 25mm for hinge/handle protection ² Locking option G available only ³ Dual locking available on model 0095 • Insurance ratings may vary dependent on risk & location. Please check with your insurers.

MULTIPLE LOCKING OPTIONS AVAILABLE – SEE PAGE 5



EURO GRADE 1

(£10,000 cash rating)*

Using the latest technology and with close consultation with what is recognised as one of the best independent test houses, these safes have been designed to perform under the toughest conditions. Their ultra modern appearance and lightweight construction allows integration in to most environments.

- Tested and certified according to EN 1143-1 Security Grade I.
- Fitted with solid steel sliding bolts on three sides, continuous hinge protection and a single security key lock.
- Multiple locking options available.
- Fire resistant door seal and base fixing point with rear fixing option included as standard. Tested to BS476-20.
- Optional fittings include adjustable shelving, a lockable compartment, metal door pocket and a rotary or tube deposit facility.
- Dual locking available on models 1095N to 1780.
- Bespoke RAL colours available – please contact us for details.



BCG £10,000 30mins 750°



3-Way Locking Bolts



Electronic Locking Option



EURO GRADE 1 SINGLE KEY LOCKING

Model	External Dimensions (mm)			Internal Dimensions (mm)			Approx. Weight (kg)	Volume (l)	Lever Arch Files	Shelves
	Height	Width	Depth ¹	Height	Width	Depth				
1015N ²	410	335	300	334	275	180	55	17	–	1
1025N ²	410	415	345	334	355	225	75	27	–	1
1035N ²	410	415	425	334	355	305	85	36	4	1
1055N ²	585	415	425	509	355	305	105	55	4	1
1085N	585	515	495	509	455	375	130	87	6	1
1095N	770	515	425	694	455	305	155	96	12	1
1120N	940	515	425	864	455	305	180	120	12	2
1180N	1,120	515	495	1,044	455	375	225	178	18	2
1410N	1,475	765	535	1,399	705	415	375	409	36	3
1535	1,850	840	580	1,720	730	415	495	521	45	4
1780 ³	1,850	1,190	580	1,720	1,080	415	665	771	70	4

¹ 45mm extra depth with handle and different locks. ² Locking option G available only. ³ Double doors.

*Insurance ratings may vary dependent on risk & location. Please check with your insurers.

MULTIPLE LOCKING OPTIONS AVAILABLE – SEE PAGE 5 • DEPOSIT OPTIONS AVAILABLE – SEE PAGE 26



EURO GRADE 2 (£17,500 cash rating)*

As with all our Euro Graded safes this model is constructed from solid steel with a composite slab door. The smallest model at 39litres capacity is one of the most compact Grade 2 safes in the market today. With a range extending to a capacity of 771litres there is a model to suit virtually any application.

- Tested and certified according to EN 1143-1 Security Grade II.
- Fitted with solid steel sliding bolts on three sides, continuous hinge protection and a single security key lock.
- Multiple locking options available.
- Fire resistant door seal and base fixing point with rear fixing option included as standard. Tested to BS476-20.
- Optional fittings include adjustable shelving, a lockable compartment, metal door pocket and a rotary or tube deposit facility.
- Dual locking available on models 2070N to 2780.
- Bespoke RAL colours available – please contact us for details.



Bespoke RAL colours available
on all grades and sizes



Auditable Electronic Lock Option

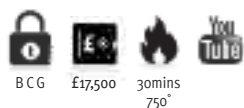
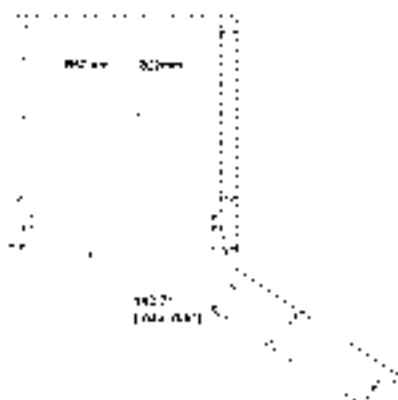

B C G £17,500 30mins
750°



EURO GRADE 2 SINGLE KEY LOCKING

Model	External Dimensions (mm)			Internal Dimensions (mm)			Approx. Weight (kg)	Volume (l)	Lever Arch Files	Shelves
	Height	Width	Depth ¹	Height	Width	Depth				
2040N ²	430	460	450	334	380	305	137	39	5	1
2070N ³	605	535	450	509	455	305	200	71	6	1
2095N ³	790	535	450	694	455	305	247	96	12	1
2175N ³	960	610	530	864	530	385	344	176	14	2
2215N ³	1,140	610	530	1,044	530	385	397	213	21	2
2285N ³	1,495	610	530	1,399	530	385	501	285	28	3
2395N ³	1,495	760	560	1,399	680	415	599	395	36	3
2440N ³	1,320	760	675	1,224	680	530	585	441	27	2
2535 ³	1,850	840	580	1,720	730	415	815	521	45	4
2780 ^{3,4}	1,850	1,190	580	1,720	1,080	415	1,045	771	70	4

¹ 45mm extra depth with handle and different locks. ² Locking option G available only. ³ Dual locking available on models 2070N to 2780. ⁴ Double doors.

*Insurance ratings may vary dependent on risk & location. Please check with your insurers.

MULTIPLE LOCKING OPTIONS AVAILABLE – SEE PAGE 5 • DEPOSIT OPTIONS AVAILABLE – SEE PAGE 26



EURO GRADE 3 (£35,000 cash rating)*

A safe tested to Grade 3 as well as providing a cash rating of up to £35,000 will also provide valuables cover of up to £350,000. This rule (x10) can be applied to the safes in all of the Securikey ranges.

- Tested and certified according to EN 1143-1 Security Grade III.
- 3-way 40mm locking bolts, continuous hinge protection and a single high security key lock or digital keypad to EN1300.
- Fire resistant door seal and base fixing point with rear fixing option included as standard. Tested to BS476-20.
- Standard fittings include adjustable shelving and an alarm connection loop.
- Optional fittings include a lockable inner compartment, metal door pocket and a rotary or tube deposit facility.
- Dual locking available on all models.
- Bespoke RAL colours available – please contact us for details.



Lockable Compartment



Solid External Hinges & Fire Seal



EURO GRADE 3 SINGLE KEY LOCKING

Model	External Dimensions (mm)			Internal Dimensions (mm)			Approx. Weight (kg)	Volume (l)	Lever Arch Files	Shelves
	Height	Width	Depth ¹	Height	Width	Depth				
3070N	600	535	464	509	455	305	275	71	6	1
3095N	785	535	464	694	455	305	340	96	12	1
3175N	955	610	544	864	530	385	480	176	14	2
3215N	1,135	610	544	1,044	530	385	550	213	21	2
3285N	1,490	610	544	1,399	530	385	660	285	28	3
3395N	1,490	760	574	1,399	680	415	830	395	36	3
3440N	1,315	760	689	1,224	680	530	860	441	27	2
3535	1,850	840	580	1,720	730	415	990	521	45	4
3780 ²	1,850	1,190	580	1,720	1,080	415	1,305	771	70	4

¹ 45mm extra depth with handle and different locks. ² Double doors. • Dual locking available on all models.

*Insurance ratings may vary dependent on risk & location. Please check with your insurers.

MULTIPLE LOCKING OPTIONS AVAILABLE – SEE PAGE 5 • DEPOSIT OPTIONS AVAILABLE – SEE PAGE 26

3070N





EURO GRADE 4 & EURO GRADE 5 DUAL LOCKING (£60,000, Grade 4 or £100,000, Grade 5)*

Euro Grade 4 and 5 offer the ultimate in cash and valuables protection. Typical installations include Banks, Diamond Merchants and Casinos.

- Tested and certified according to EN 1143-1 and fitted with 2 locks to EN 1300.
- Fitted with 40mm steel sliding bolts.
- Fire resistant door seal and base fixing points. Tested to BS476-20.
- Electronic locking options available.
- Standard fittings include adjustable shelving and alarm connection loop.
- Optional lockable inner compartment, metal door pocket and rotary or tube deposit facility.
- Bespoke RAL colours available – please contact us for details.

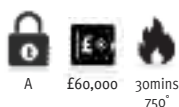

4080N



5535



EURO GRADE 4 DUAL LOCKING (KEY/MECHANICAL COMBINATION)

Model	External Dimensions (mm)			Internal Dimensions (mm)			Approx. Weight (kg)	Volume (l)	Lever Arch Files	Shelves
	Height	Width	Depth ¹	Height	Width	Depth				
4080N	600	610	464	509	530	305	315	82	7	1
4095N	785	535	464	694	455	305	355	96	12	1
4175N	955	610	544	864	530	385	495	176	14	2
4215N	1,135	610	544	1,044	530	385	565	213	21	2
4285N	1,490	610	544	1,399	530	385	675	285	28	3
4395N	1,490	760	574	1,399	680	415	845	395	36	3
4440N	1,315	760	689	1,224	680	530	875	441	27	2
4535	1,850	840	580	1,720	730	415	1,165	521	45	4
4780 ²	1,850	1,190	580	1,720	1,080	415	1,450	771	70	4

¹ 45mm extra depth with handle and different locks. ² Double doors • Doors open to 205° • *Insurance ratings may vary dependent on risk & location. Please check with your insurers.



EURO GRADE 5 DUAL LOCKING (KEY/MECHANICAL COMBINATION)

Model	External Dimensions (mm)			Internal Dimensions (mm)			Approx. Weight (kg)	Volume (l)	Lever Arch Files	Shelves
	Height	Width	Depth ¹	Height	Width	Depth				
5100 ³	840	620	566	680	440	320	705	96	10	1
5150 ³	1,190	620	566	1,030	440	320	935	145	15	2
5245 ³	1,380	710	621	1,220	530	375	1,280	242	21	2
5280 ⁴	1,530	710	621	1,370	530	375	1,325	272	28	3
5425 ⁴	1,530	910	661	1,370	730	415	1,570	415	36	3
5535 ⁴	1,880	910	661	1,720	730	415	1,880	521	45	4
5780 ^{2,4}	1,880	1,260	661	1,720	1,080	415	2,380	771	70	4

¹ 45mm extra depth with handle and different locks. ² Double doors. ³ Doors open to 205°. ⁴ Doors open to 170°.

*Insurance ratings may vary dependent on risk & location. Please check with your insurers.

MULTIPLE LOCKING OPTIONS AVAILABLE – SEE PAGE 5 • DEPOSIT OPTIONS AVAILABLE – SEE PAGE 26



STRONGROOMS & SAFETY DEPOSITS

(Grade 0-9)

The Modulprim is a bespoke, on-site-assembled modular vault solution for both new build and existing buildings that require a high security room. Consisting of four walls, a floor, ceiling and vault door, Modulprim offers a complete storage facility for money, important documents and other valuables.

These vaults can also be supplied as a 5-sided solution (walls and ceiling) if desired, which is often a requirement for the pharmaceuticals market. All vault elements are subjected to extremely rigorous tests to meet European security standard EN1143-1. These were undertaken at the VdS in Germany, ensuring European wide approval, and each product is branded with the appropriate badge as proof of certification.

Modulprim construction – advantages

- Thin walls enable high usability of space
- The installation of a vault on upper floors and within a existing facility
- Modulprim components are welded together from smaller panels allowing installation in difficult to reach locations such as cellars via narrow passage ways, it is also possible to disassemble the vault and transfer to another location

The table below displays the recommended overnight cash rating for our modular vaults. Strongrooms at the lower grades (0-5) are constructed in the same manner as our Euro Grade freestanding safes. Both Strongrooms and Free Standing safes meet the requirements of EN1143-1

Grade 0:	£6000 Cash Rating
Grade 1:	£10,000 Cash Rating
Grade 2:	£17,500 Cash Rating
Grade 3:	£35,000 Cash Rating
Grade 4:	£60,000 Cash Rating
Grade 5:	£100,000 Cash Rating
Grade 6:	£150,000 Cash Rating
Grade 7:	£250,000 Cash Rating
Grade 8:	£400,000 Cash Rating
Grade 9:	£650,000 Cash Rating

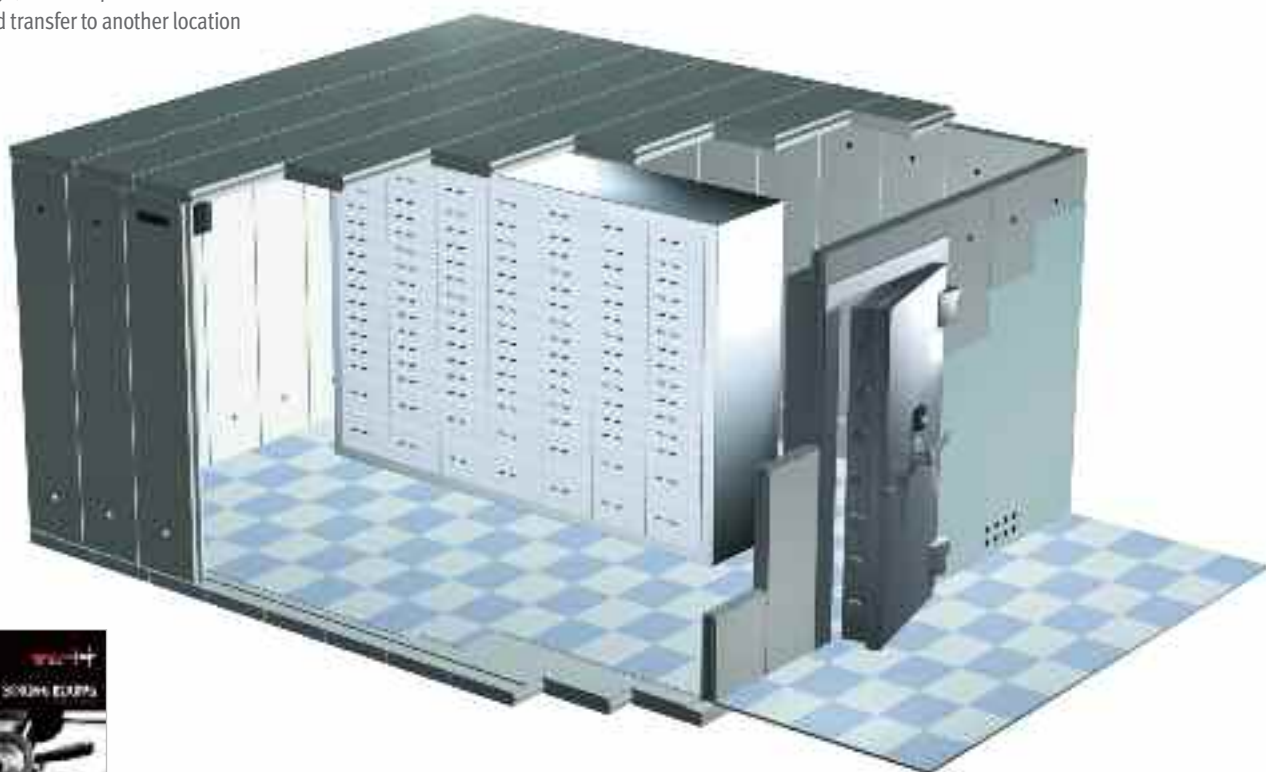

DOWNLOAD THE STRONG ROOMS BROCHURE FROM WWW.SECURIKEY.CO.UK FOR FURTHER DETAILS

DEPOSIT SAFES

In most commercial environments there is a need for a deposit safe, somewhere where you can safely deposit items such as cash, keys and other valuables without the need for keys and codes to open the safe and without drawing attention to its existence. Securikey provides a wide range of quality deposit safes, with a variety of cash ratings and deposit methods, which offer total flexibility in the workplace.

MINI VAULT SILVER (SEE PAGE 18):

- Ideal under desks or counters.
- Available with letter slot deposit (Mini Vault 1) or front hopper deposit (Mini Vault 2).

EURO GRADE (SEE PAGES 20):

- A wide range of models suitable for most applications.
- A choice of 3 different deposit methods including rotary drum, letter slot or capsule deposit tube.
- The secondary installation of a rotary drum or capsule deposit requires removal of the VdS badge. Please inform your insurers accordingly.

UNDERFLOOR SAFES (SEE PAGE 27):

- Ideal for use where space is at a premium.
- Deposit tube diameter is 52mm.

STEEL STOR (SEE PAGE 30):

- SCDR48 offers a top loading rotary deposit drum with a 90mm x 250mm aperture. A spring return ensures the drum is always closed.
- SC60 and SC100 can be supplied with a front loading rotary drum deposit, having an aperture of 90mm x 200mm x 220mm.
- SC60WDD is equipped with a lockable front deposit drawer thus removing the need to open the cabinet. It features a 240mm x 160mm x 75mm drawer aperture.

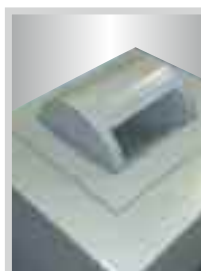

Rotary Drum



Mini Vault 2 Deposit



SC60WDD

STEEL STOR

Model	External Dimensions (mm)			Weight (kg)
	Height	Width	Depth	
SCDR48	480	320	320	42
SC60WDD*	760	540	400	110

*Supplied with 1 shelf and 2 door boxes.

UNDERFLOOR SAFES

Model	External Dimensions (mm)			Weight (kg)
	Height ¹	Width	Depth	
Housesafe Extra Deposit	305	305	305	24
Protector 3 Deposit Body	320	360	270	18.5
Protector 5 Deposit Body	410	360	270	20.5

¹ Excludes neck.

MINI VAULT SILVER

Model	External Dimensions (mm)			Internal Dimensions (mm)			Aperture Size (mm)		Weight (kg)	Volume (l)
	Height	Width	Depth	Height	Width	Depth	Height	Width		
Mini Vault 1 Deposit	294	374	325	210	365	260	20	140	31	15
Mini Vault 2 Deposit	532	374	425	260	365	360	100	250	57	34

Deposit models and modifications can result in reduced cash ratings. Please check with your insurers.

ALTERNATIVE LOCKING OPTION AVAILABLE – SEE PAGE 5

UNDERFLOOR & DIY SAFES

(Up to £10,000 cash rating)*

Underfloor safes are designed for installation in a concrete style floor. The level of protection provided due to the nature of the installation and location possibilities is huge. Our DIY safe range is deemed suitable for installation with little or no specialist knowledge. Advice on the installation of this product will be provided at point of purchase.

PROTECTOR RANGE:

- Available in five models with a choice of interchangeable doors covering 3 cash ratings.
- High level of security with interlocking bolts controlled by a key or keyless combination and anti-drill features.
- ABP models protect against thermal attack.

HOUSESAFE RANGE:

- Available in three models and secured with a high quality safe lock.
- Economic way of protecting cash, valuables, vital documents.

DIY RANGE:

- Secure storage for A4 papers, passports, insurance certificates or jewellery.
- Models to install under a timber floor or for surface mounting.

Strongbox Extra
Euro Profile Lock



£1,000

DIY SAFES

Model	External Dimensions (mm)			Weight (kg)
	Height	Width	Depth	
Strongbox Extra Euro Profile Lock	130	400	235	12
Cupboard Safe Euro Profile Lock	130	350	235	12
Strongbox Extra	130	400	235	12.5



£3,000

HOUSESAFE – BODY AND DOOR

Model	External Dimensions (mm)			Weight (kg)
	Height ¹	Width	Depth	
Housesafe Extra – Size 1	330	230	305	17
Housesafe Extra – Size 2	405	305	305	23
Housesafe Extra Deposit	405	305	305	24

¹ Includes neck height of 100mm. • Aperture = 166 x 166mm.

*Insurance ratings may vary dependent on risk & location. Please check with your insurers.

Protector ABP Door



Housesafe 1 Extra



Protector 3 Deposit



B



Up to
£10,000

PROTECTOR – BODIES

Model	External Dimensions (mm)			Weight (kg)
	Height ¹	Width	Depth	
Protector 1	380	360	270	14.5
Protector 2	470	360	270	16.5
Protector 3 Deposit	470	360	270	18.5
Protector 4	560	360	270	18.5
Protector 5 Deposit	560	360	270	20.5

¹ Includes neck height of 150mm. • Aperture = 227 x 180mm.

PROTECTOR – DOORS

Model	External Dimensions (mm)			Weight (kg)	Cash Rating
	Height	Width	Depth		
Protector Minor	–	247	200	7.5	£4,000
Protector	–	247	200	10.5	£6,000
Protector ABP ²	–	247	200	11	£10,000

² Extra Protection against attack with Oxy-Acetylene.

ALTERNATIVE LOCKING OPTION AVAILABLE – SEE PAGE 5 • FULL RANGE OF DEPOSIT SAFES – SEE PAGE 26

GUN CABINETS

These gun and ammunition cabinets exceed the UK standard (BS 7558) for storing firearms and utilise 3-way 25mm locking bolts, secured by a single high security key lock to EN 1300. Concealed hinges and continuous hinge side protection offer superior resistance from attack.

- Multi point locking with 8-lever safe lock.
- Gun cabinets are supplied with a trigger lock to prevent unauthorised use of a firearm during transportation.
- Ammunition cabinet is supplied with 2 shelves.



Ammunition Cabinet



Turnbull 1

Turnbull 2



Fixed Shelf – Turnbull 2



Trigger Lock



High Security 8 lever safe lock

GUN CABINETS

Model	External Dimensions (mm)			Internal Dimensions (mm)			Weight (kg)	Max. Capacity (Weapons)
	Height	Width	Depth ¹	Height	Width	Depth		
Turnbull 1 ¹	1,250	300	285	1,230	290	220	63	7
Turnbull 2 ¹	1,500	380	285	1,480	370	220	84	9
Ammunition Cabinet	532	374	230	522	354	165	38	–

¹ Includes a free gun trigger lock 90D for use during transportation. • Turnbull 2 - 1260mm to underside of fixed shelf



SECURE STOR

(£2,000 cash rating)*

Secure Stor offers an economic solution to the ever increasing problem of safe storage of high value bulk items.

Whilst built to the same exacting standards as the Steel Stor range, these units are tested to EN14450 S1 and certified by VdS in Germany. Manufactured with a 3mm solid steel body, with 3-way locking mechanism and VdS approved class 1 safe lock. The internal hinges allow the door to open 102°. Hardened steel plates protect all other areas prone to attack. Available in five sizes with an alternative electronic locking option, the cabinet is supplied with prepared base fixing points and shelves.



SC050 Key or Electronic



SC110 Key or Electronic



SC215



£2,000

SECURE STOR

Model	External Dimensions (mm)			Internal Dimensions (mm)			Weight (kg)	Volume (l)	Shelves
	Height	Width	Depth	Height	Width	Depth			
SC050	430	446	364	377	430	305	35	49	1
SC065	550	446	364	497	430	305	42	65	1
SC110	790	496	364	737	480	305	55	108	1
SC155	1,150	496	364	1,097	480	305	76	161	2
SC215	1,510	496	364	1,457	480	305	96	213	3

*Insurance ratings may vary dependent on risk & location. Please check with your insurers.

MULTIPLE LOCKING OPTIONS AVAILABLE – SEE PAGE 5 • DEPOSIT OPTIONS AVAILABLE – SEE PAGE 26

STEEL STOR

(£3,000 cash rating)*

The Steel Stor range is extremely well suited to the secure storage of controlled drugs, cigarettes, bags of change examination papers and other bulky valuable items. Subjected to a severe burglary and attack test, these cabinets are used in many Hospitals, Government Departments, Schools and Retail premises.

- Subjected to a severe Norwegian burglary test.
- 4mm steel body with 3-way locking bolts and a VdS class 1 approved safe lock.
- Fitted with a continuous dog bar over the hinged side of the door and hardened plates to protect against attack.
- Cabinet is supplied with prepared base fixing points, shelves and door boxes.
- Dual locking facility available on all models, (except SCo60).
- Additional fittings available - Shelves, Rotary Drum Deposit (SCo60 & SC100 only).
- **Used extensively by Government offices, when fitted with the appropriate approved lock.**



Door Boxes



STSC100



STANDARD

Model	External Dimensions (mm)			Internal Dimensions (mm)			Weight (kg)	Volume (l)	Shelves	Door Boxes
	Height	Width	Depth	Height	Width	Depth				
SCo60	600	540	400	565	520	320	67	94	1	2
SC100	1,000	600	450	965	580	370	154	207	2	3
SC149D	1,490	540	400	1,455	520	320	158	247	3	4
SC160	1,600	600	450	1,565	580	370	192	336	3	4
SC160D	1,600	600	700	1,565	580	620	235	563	4	4
SC180D	1,800	850	700	1,765	830	620	302	908	4	12

*Insurance ratings may vary dependent on risk & location. Please check with your insurers.

MULTIPLE LOCKING OPTIONS AVAILABLE – SEE PAGE 5 • DEPOSIT OPTIONS AVAILABLE – SEE PAGE 26

MEDICAL STORAGE

Our range of Medical Storage Cabinets are designed using our extensive knowledge of the protection and control of cash and valuables. The 'Bronze Level' Medical Cabinet is suitable for storing general First Aid items, whilst the 'Silver & Gold' units are perfect for controlled drugs that are governed by the Home Office Drugs Inspectorate direction of control.

- **Bronze level** cabinet features: 1.5mm pressed steel construction with security cam lock, shelves and lockable inner compartment.
- **Silver level** cabinet features: 4mm body with 8mm anti-bludgeon door fitted with 8-lever safe lock to EN 1300 and includes 2 shelves.
- **Gold level** Choice of body thickness - 3mm (Secure Stor) or 4mm (Steel Stor) for added security. Both ranges feature multi point locking and adjustable shelves. Steel Stor also includes door boxes to maximise the space available. (see Secure Stor page 29 or Steel Stor page 30).

Gold and Silver cabinets conform to the construction required for the misuse of drugs (safe custody) regulation 1973.



Secure Stor SC050



Gold Rated



Medical Cabinet



Bronze Rated



Medicine Cabinet



Silver Rated

MEDICAL

Model	External Dimensions (mm)			Internal Dimensions (mm)			Weight (kg)	Volume (l)	Shelves	Door Boxes	Internal Lockable Compartment
	Height	Width	Depth	Height	Width	Depth					
Medical Cabinet 1	350	300	120	—	—	—	4	—	2	—	—
Medical Cabinet 2	450	300	140	—	—	—	6	—	1	—	Yes
Medical Cabinet 3	550	380	205	—	—	—	11	—	2	—	Yes
Medicine Cabinet	532	374	230	522	354	165	38	30	2	—	—
Secure Stor SC050	430	446	364	377	430	305	35	49	1	—	—
Steel Stor SC100 ¹	1,000	600	450	965	580	370	154	207	2	3	—

¹ Alternative sizes available in both ranges, see page 29 and 30.

POST BOXES

HIGH SECURITY POST BOXES:

Our sleek, weatherproof High Security Post Boxes are available in two sizes and have been designed for outdoor environments to protect letters and small packets from theft. As part of our One Key Solution range, High Security Post Boxes offers the potential for integration with existing ‘single key’ systems, simplifying security and offering increased flexibility.

- 1.5mm thick steel with Euro Profile locking

STANDARD POST BOXES:

Utilising high grade steel, powder coating and high quality cam lock, these fabricated post boxes are built to the same exacting standards as our ‘System’ key cabinets. Available in two sizes with the option of front or top loading, both sizes will accept A4 comfortably. To avoid rattling in strong winds, noise dampening materials have been incorporated.

- Quality cam lock and powder coated to give years of service



HIGH SECURITY POST BOXES

Top Loading Model	External Dimensions (mm)			Slot (mm)		Weight (kg)
	Height	Width	Depth	Width	Depth	
Medium Post Box	375	300	120	295	40	6
Large Post Box	550	380	140	375	40	10

STANDARD POST BOXES

Top Loading Model	External Dimensions (mm)			Slot (mm)		Weight (kg)
	Height	Width	Depth	Width	Depth	
Medium Post Box	365	270	110	245	36	2.5
Large Post Box	370	365	110	350	36	4.1
Front Loading Model	External Dimensions (mm)			Slot (mm)		Weight (kg)
	Height	Width	Depth	Width	Depth	
Medium Post Box	365	250	110	210	36	2.5
Large Post Box	370	365	110	325	36	4.3



High Quality Cam Lock



Euro Profile Cylinder Lock



FIRE VAULT & FIRE RESISTANT FILING CABINETS	30
FIRE STOR	31



FIRE SAFES & CABINETS

In the aftermath of a fire, access to important documents such as insurance policies, wills, passports and certificates is essential to getting back on your feet. The Securikey range of modern, high security, fire resistant safes and vaults is manufactured to the highest standards and independently tested and approved for both fire protection and physical attack.

MULTIPLE SIZE OPTIONS • SECURE STORAGE • CERTIFIED AND TESTED
ALTERNATIVE LOCKING OPTIONS • DOMESTIC & COMMERCIAL USE



FIRE VAULT & FIRE RESISTANT FILING CABINETS

(£2,000 cash rating)*

FIRE RESISTANT FILING CABINETS:

- Designed for the safekeeping of paper files.
- Adjustable hanging rails accept all file sizes.
- Independently tested and certified.
- Drawers are mounted on a rugged suspension system.
- Flush handles to prevent injury.

FIRE VAULT:

- Independently tested and certified.
- Withstands temperatures of up to 950°C for an hour.
- Reliable electronic lock with selectable code lengths.
- All models feature key hanger, drawer and shelf.**
- Optional non-invasive fixing system available.



4-Drawer Filing Cabinet



Fire Vault 0



60mins
950°

FILING CABINETS

Model	External Dimensions (mm)			Weight (kg)
	Height	Width	Depth	
4-Drawer Filing Cabinet	1,406	528	675	266



£2,000
60mins
950°

FIRE VAULT

Model	External Dimensions (mm)			Internal Dimensions (mm)			Weight (kg)	Capacity (l)	Shelves
	Height	Width	Depth	Height	Width	Depth			
Fire Vault 0 ¹	360	412	363	260	320	234	34	19	–
Fire Vault 1 ¹	420	352	433	320	260	304	37	25	1
Fire Vault 2 ¹	522	404	440	410	300	300	56	37	1

¹ Can be supplied with a non-invasive fixing base plate to prevent removal. This secures the safe to the floor without compromising the integrity of the fire protection.

**Insurance ratings may vary dependent on risk & location. Please check with your insurers. **Where applicable.



Fire Vault 1



FIRE STOR

(£2,000 cash rating)*

Our range of secure fire and burglary resistant storage cabinets are an affordable solution for the safekeeping of both valuables and documents. The cabinets are double-walled with a fire resistant barrier material to DIN 4102. The inclusion of this second level of protection gives these cabinets their fire resistance. In addition, they have undergone a burglary test and so are well suited to the storage of valuables up to the value of £20,000.

- Tested and complies with EN 14450 – S1.
- Double walled construction with fire resistant filling to DIN 4102.
- Each model is fitted as standard with five heavy-duty locking bolts secured on three sides and a VdS approved safe lock.
- Additional options include an internal lockable compartment (180mm high on single door version, 300mm high on the double door version), pull-out frames for drop files and additional shelves.



Fire Stor Range



1021



BC

£2,000

FIRE STOR

Model	External Dimensions (mm)			Internal Dimensions (mm)			Weight (kg)	Lever Arch Capacity ¹	Capacity (l)	Shelves
	Height	Width	Depth	Height	Width	Depth				
1023	860	600	520	690	490	405	95	12	137	1
1022	1,220	600	520	1,050	490	405	120	18	208	2
1021	1,580	600	520	1,410	490	405	145	24	280	3
1020	1,950	930	520	1,780	820	405	215	50	591	4
1024	1,950	1200	520	1,780	1,090	405	245	65	786	4

¹ Suggested capacities for Lever Arch files – 80mm width. • *Insurance ratings may vary dependent on risk & location. Please check with your insurers.

MULTIPLE LOCKING OPTIONS AVAILABLE – SEE PAGE 5



KEYLEX MECHANICAL DIGITAL LOCKS

Access control is vital to providing a secure environment and ensuring the integrity of a building or area and the safety of staff. Our range of Keylex mechanical digital locks offer a simple, convenient and effective solution and offers a number of advantages over keyed locking systems. While not requiring keys, cards or tokens which can be damaged, lost or stolen, they're also totally self-contained and don't require any additional hardware. Reinstating security is quick and easy if codes are compromised.

SAFETY IN NUMBERS • LIGHT COMMERCIAL & INDUSTRIAL USE • INDOOR & OUTDOOR APPLICATIONS
USED BY MILITARY, POLICE, BANKS AND BUILDING SOCIETIES

MECHANICAL DIGITAL LOCKS

500 – MINI:

- Narrow design suits timber doors with stile widths down to a minimum of 80mm.
- Suitable for low-security internal door installations.

800 – LIGHT DUTY:

- Narrow design suits aluminium hollow metals sections with stile widths down to a minimum of 80mm.
- Optional key override facility.

700 – MEDIUM DUTY:

- The integral slipping clutch mechanism and narrow-stile design suits aluminium hollow metals sections with stile widths down as low as 43mm.
- Suitable for high-security external door installations and on any door where a flexible euro profile keying system is required.
- Models available to suit Adams Rite Latch and Multi-Point Door Locks

2100 – HEAVY DUTY:

- Will withstand all but the most violent attack and will provide many years of service.
- Suitable for all external door installations and on any door where heavy traffic or extreme use and misuse is expected.



Mortice Sash Lock



Heavy Duty Deadlocking Latch



Tubular Deadlocking Latch

500/800 LIGHT DUTY

Model	Colour Finish
500 – c/w tubular latch – Standard passage	Silver
500 – Rim version	Silver
800 – c/w heavy duty latch – Standard passage	Silver or Dark Bronze
800 – c/w heavy duty latch – Key override	Silver or Dark Bronze

700 – MEDIUM DUTY

Model	Colour Finish
700 – External code unit, inside lever furniture and escutcheons	Silver or Dark Bronze
700 M – Multi point UPVC doors	Silver
700 AR – For Adams Rite deadlatch	Silver
700 ARFP – For Adams Rite deadlatch with free passage	Silver
Non-handed mortice sash lock case 60mm backset	Satin Stainless Steel
Double euro profile cylinder – 60mm	Satin Nickel

2100 – HEAVY DUTY

Model	Colour Finish
2100 – c/w heavy duty latch – Standard Passage 60 or 76mm backset	Satin Chrome or Antique Brass
2100 – c/w heavy duty latch – Key override	Satin Chrome or Antique Brass

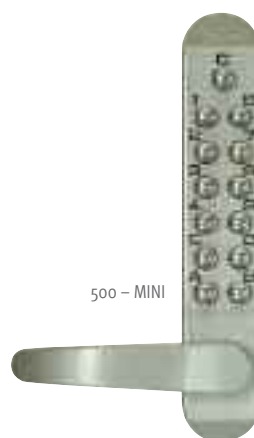

500 – MINI



2100 – Heavy Duty



700 – Medium Duty



800 – Light Duty



DOWNLOAD THE FULL KEYLEX BROCHURE FROM WWW.SECURIKEY.CO.UK FOR FURTHER DETAILS.



Model: M18535HE Deluxe Half Face

INTERIOR & EXTERIOR	35
SPECIALITY	36
INSTITUTION	37



CONVEX MIRRORS

Strategically placed, our extensive range of convex mirrors are used to improve security, safety and operational efficiency in a diverse range of environments, from Factories to Warehouses, on Shop floors and in Hospitals, in Police Stations and Prisons – eliminating blind spots and improving surveillance where visibility is poor.

ELIMINATING BLIND SPOTS • IMPROVING SURVEILLANCE • INTERNAL/EXTERNAL OPTIONS
HIGH QUALITY CONSTRUCTION • AVAILABLE IN ACRYLIC AND STAINLESS STEEL

Viewing Distance:

This is the combined distance from the observer to the mirror **PLUS** the distance from the mirror to the object being observed.

INTERIOR & EXTERIOR MIRRORS

- Eliminate blind spots.
- Improves safety, prevents accidents and injuries.
- Act as a powerful deterrent against crime.
- Tough ACM back, ideal for industrial situations.
- Low maintenance.
- Ideal for Factories, Warehouses, Hospitals, Car Park entrances and exits



360° Ceiling Dome



Exterior Heavy Duty

Exterior Heavy Duty
'J' arm Bracket

INTERIOR CONVEX

Model	Description (mm)	Viewing Distance (M)	Acrylic Face Thickness (mm)	Back
M18020J	300 diameter	5	2	ACM
M18038J	450 diameter	7	2	ACM
M18056J	600 diameter	10	2	ACM
M18108J	900 diameter	18	2	Vinyl Celuka
M18330A	600 x 400 rectangular	13	2	—

Supplied with bright zinc "J" arm bracket. ACM = Aluminium Composite Material.

INTERIOR HEMISPHERE "QUARTER FACE"

Model	Description (mm)	Viewing Distance (M)	Acrylic Face Thickness (mm)	Back
M18541H	300 x 300 quarter face	3	2	—
M18562H	450 x 450 quarter face	6	3	—

Designed for corner fixing ideal for observation and as a deterrent. Dome top screws supplied.

INTERIOR HEMISPHERE "HALF FACE"

Model	Description (mm)	Viewing Distance (M)	Acrylic Face Thickness (mm)	Back
M18535H	600 x 300 half face	6	2	—
M18535HE	600 x 300 deluxe half face	6	3	—
M18552H	900 x 450 half face	9	3	—

Designed for walls above shop fixtures and for anti-collision purposes. Dome top screws supplied.

INTERIOR HEMISPHERE 360° "CEILING DOME"

Model	Description (mm)	Viewing Distance (M)	Acrylic Face Thickness (mm)	Back
M18585H	600 diameter	6	2	—
M18580HE	900 diameter	9	3	—

Dome top screws supplied for mounting on ceiling and suspension kit for adjustment to optimum height.

INTERIOR/EXTERIOR

Model	Description (mm)	Viewing Distance (M)	Acrylic Face Thickness (mm)	Back
M18036JP	400 diameter	7	2	ACM
M18056JP	600 diameter	10	2	ACM

Supplied with bright zinc "J" arm bracket. ACM = Aluminium Composite Material.

EXTERIOR HEAVY DUTY

Model	Description (mm)	Viewing Distance (M)	Acrylic Face Thickness (mm)	Back
M18044S	450 diameter	28	2	Vinyl Celuka ¹
M18062S	600 diameter	38	2	Vinyl Celuka ¹
M18114S	900 diameter	55	3	Vinyl Celuka ¹

Supplied with bright zinc "J" arm bracket. ¹ 10mm.

EXTERIOR HEMISPHERE HALF DOME

Model	Description (mm)	Viewing Distance (M)	Acrylic Face Thickness (mm)	Back
M18535HO	600 x 300 Half Face	9	2	Vinyl Celuka ¹
M18553HO	900 x 450 Half Face	12	2	Vinyl Celuka ¹

Supplied with bright zinc "J" arm bracket. ¹ 10mm.

EXTERIOR DELUXE HEAVY DUTY

Model	Description (mm)	Viewing Distance (M)	Acrylic Face Thickness (mm)	Back
M18066D	600 diameter	38	3	Powder Coated Steel
M18087D	800 diameter	50	3	Powder Coated Steel
M18445D	1,000 diameter	over 60	3	Powder Coated Steel

Supplied with bright zinc "J" arm bracket and post mounting kit to suit 75mm post.

SPECIALITY MIRRORS



Retail Security



Traffic Management



Heavy Duty Exterior Fixings



Warehouse Safety



Food Process Monitoring



Unbreakable / Anti-Vandal

FOOD PROCESSING ACRYLIC

Model	Description (mm)	Viewing Distance (M)	Face Thickness (mm)	Back
M18244V	450 diameter	7	2	Moulded ASA Vinyl
M18266V	600 diameter	10	2	Moulded ASA Vinyl
M18287V	800 diameter	14	3	Moulded ASA Vinyl

Supplied with stainless steel 'J' arm bracket

FOOD PROCESSING STAINLESS STEEL

Model	Description (mm)	Viewing Distance (M)	Face Thickness (mm)	Back
M16144FE	450 diameter	7	0.7	Stainless Steel
M16166FE	600 diameter	10	0.9	Stainless Steel
M16187FE	800 diameter	14	0.9	Stainless Steel

Supplied with stainless steel 'J' arm bracket

FORK LIFT REAR VIEW

Model	Description (mm)	Viewing Distance (M)	Acrylic Face Thickness (mm)	Back
M19952A	300 x 150 half face	12	2	Moulded ASA Vinyl
M19952T	300 x 150 half face	12	2	—

TRAFFIC MIRRORS

Model	Description (mm)	Viewing Distance (M)	Acrylic Face Thickness (mm)	Back
M18666CS	600 diameter	38	2	Moulded ASA Vinyl
M18687CS	800 diameter	46	2	Moulded ASA Vinyl
M18642R	600 x 400 rectangular	38	2	Moulded ASA Vinyl
M16336C ²	320 x 225 rectangular	23	0.7	Stainless Steel

Supplied with 75mm diameter pole mounting brackets

² Supplied with 32mm diameter pole clamp bracket only.

ANTI-VANDALISM STAINLESS STEEL

Model	Description (mm)	Viewing Distance (M)	Face Thickness (mm)	Back
M500CD	500 ceiling dome	5	1.2	—
M16047C ¹	450 diameter	32	0.7	Powder Coated Steel
M16066C ¹	600 diameter	42	0.7	Powder Coated Steel
M16505W	500 wall dome	30	0.9	—
M16525HL	250 x 250 quarter face	5	1.2	—
M16529HL	500 x 250 half face	6	1.2	—

¹ Supplied with wall and 75mm diameter pole mounting brackets.

SPECIALIST & INSTITUTION MIRRORS



Police & Prison Cells



Quarter Face with Anti-Ligature Frame



Secure Institutions



Pedestrian Safety



Under Vehicle Inspection



Motor Vehicle inspection

PORTABLE INSPECTION

Model	Description (mm)	Viewing Distance (M)	Acrylic Face Thickness (mm)	Back
M18660	150 diameter	3	2	ACM
M18662	230 diameter	4	2	ACM
M18664 ¹	450 diameter	4	2	ACM

¹Mounted on castors. ACM = Aluminium Composite Material

ILLUMINATED HEAVY DUTY PORTABLE INSPECTION MIRROR

Model	Description (mm)	Viewing Distance (M)	Acrylic Face Thickness (mm)	Back
MHL230SB	230 diameter	4	2	ACM
MHL300SB ¹	300 diameter	6	2	ACM

¹Mounted on castors. ACM = Aluminium Composite Material
Supplied with a protective bag for safe storage, when not in use

FIXING KITS

Model	Description
M21102TD	Torch Mount Kit for D-Cell Maglite (torch not supplied)
M21121	U Bolt Fixing Kit for 60mm pole
M21122	U Bolt Fixing Kit for 75mm pole
M21030	Traffic Mirror Wall Mounting Plate

INSTITUTIONAL POLYCARBONATE – ANTI-LIGATURE

Model	Description (mm)	Viewing Distance (M)	Face Thickness (mm)	Back
M17527H	300 x 300 quarter face	6	3	–
M17537H	600 x 300 half face	6	3	–

INSTITUTIONAL STAINLESS STEEL – ANTI-LIGATURE

Model	Description (mm)	Viewing Distance (M)	Face Thickness (mm)	Back
M16525HL	250 x 250 quarter face	5	1.2	–
M16529HL	500 x 250 half face	6	1.2	–
M500CD	500 ceiling dome	5	1.2	–

MOT TEST MIRROR

Model	Description (mm)	Viewing Distance (M)	Acrylic Face Thickness (mm)	Back
M20405	400 diameter	10	2	ACM

FULL FURTHER DETAILS ON OUR EXTENSIVE CONVEX MIRROR RANGE PLEASE VISIT OUR WEBSITE AT WWW.SECURIKEY.CO.UK/CONVEXMIRRORS



MASTER LOCK®

Master Lock® is recognised around the world as the solid, enduring name in padlocks and security products. Generations of people have grown up with Master Lock® products at Home, School and Work. Master Lock® Europe, listening carefully to its markets, develops specific ranges of products designed to meet the needs of every country. Our customers expect our locks to be reliable, durable, and functional. Above all, they must be secure.

RELIABLE • DURABLE • FUNCTIONAL • HIGH SECURITY • WEATHER PROTECTED
ATTACK RESISTANT • DOMESTIC, COMMERCIAL & INDUSTRIAL USE



Master Lock® are the largest global manufacturer of padlocks and safety/security devices:

PADLOCKS WITH KEYS

- Low to medium security ranges manufactured from brass, aluminium, laminated & stainless steel.
- High Security ranges - Pro Series and Excell in brass, laminated, stainless and hardened steel.
- Complimentary range of hasps, cables and chains to suit.

COMBINATION PADLOCKS:

- With 3 or 4-digit fixed and re-settable combinations. Ideal for luggage, sports bags, school lockers, gym lockers, gates, sheds, bikes, anywhere keyless security is required.

LOCKER LOCKS:

- A choice of 3-digit fixed combination padlocks or 'built-in' combination locks with management override control.

KEY STORAGE

- Key storage solutions that only allow those you trust access. Used by maintenance workers, district nurses, cleaners, home helpers and children after school.

SAFETY LOCKOUT / TAGOUT

- Protects your employees when carrying out repairs or routine maintenance to plant/machinery. Vital in preserving life and preventing prosecution.



THE COMPLETE MASTER LOCK RANGE IS TOO EXTENSIVE TO FEATURE IN THIS PRODUCT GUIDE. IT IS AVAILABLE AS A SEPARATE CATALOGUE, DOWNLOADABLE FROM WWW.SECURIKEY.CO.UK OR CONTACT US FOR A COPY.



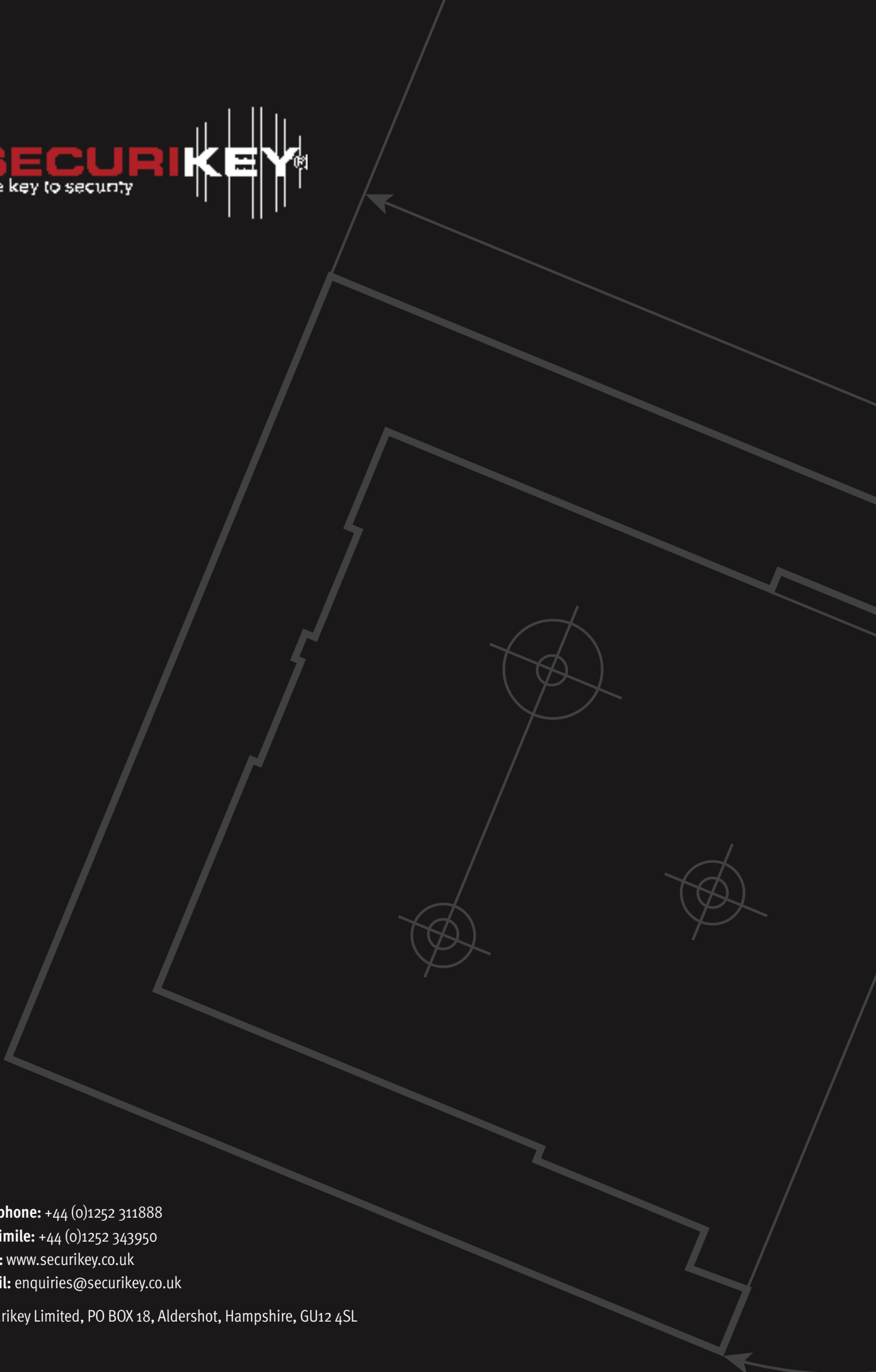

Telephone: +44 (0)1252 311888

Facsimile: +44 (0)1252 343950

Web: www.securikey.co.uk

Email: enquiries@securikey.co.uk

Securikey Limited, PO BOX 18, Aldershot, Hampshire, GU12 4SL